



Shining bright at 2000 ANSI lumens, the XD205R is a lightweight, easy to use projector for the cost conscious presenter.

XGA Performance at an Affordable Cost

The XD205R is an XGA DLP™ projector that provides a bright 2000 ANSI lumens picture at an affordable price. It is a filter-free 2000:1 contrast ratio projector with both data and video connectivity that only weighs 5.3 lbs for convenient portability. It is also backed by Mitsubishi's exclusive ERA and Warranty programs making it high featured projector at an affordable cost.

- DLP™ technology
- Native XGA (1024x768) resolution
- 2000 ANSI lumens and a contrast ratio of 2000:1
- Lightweight at only 5.3 lbs
- Anti-theft security hook
- Flexible connectivity options with support for monitor loop through
- 3-years or 10,000-hours on the TI-DLP DMD Chip, 3-years parts and labor, 3-years Express Replacement Assistance (ERA), 90-days lamp warranty

XD205R

XGA DLP™ PROJECTOR



DISPLAY TECHNOLOGY
 0.55", 1-Chip DMD, 12 deg. DDR, DDP2000
 1024 x 768 (Total 786,432 pixels), 550 Video Lines
RESOLUTION
 2000 ANSI lumens (1700lm low lamp mode)
BRIGHTNESS
 2000 : 1 (on/off)
CONTRAST RATIO
 Manual Focus & Zoom Lens
ZOOM/FOCUS
 Projection Lens
 F= 2.4 (Wide) 100°@3.2 m (Wide)
PROJECTION LENS
 1.56 - 1.87
THROW RATIO
 7.9 : -1 up (No variable lens shift)
OFF SET AXIS
 40-300 diagonal inches
PICTURE SIZE
 205W (Shut Off Time 2000 Hrs) with Low Mode (16AW: Shut Off Time 3000 Hrs)
SOURCE LAMP
 Resolution: 640 x 480 - 1024 x 768 + Compressed 1280 x 1024 Sync on Green available
PC COMPATIBILITY
 NISCN/NTSC 4.43/PAL (including PAL-M, N)/SECAM/PAL-60, Component Video: 480i/p
VIDEO COMPATIBILITY
 (525i/p), 576i/p (625i/p), 720p (750p), 1080i (1125i 60Hz), 1080i (1125i 50Hz)

INPUT TERMINALS
 RGB: Mini D-sub 15pin x 1
 Audio: Stereo Mini Jack (ø 3.5mm) x 1
 Video: RCA x 1 + S-VIDEO x 1

OUTPUT TERMINAL
 RGB: Mini D-sub 15pin x 1
 Audio: Stereo minijack (ø 3.5mm) x 1 (variable lineout)

COMMUNICATION TERMINAL
 USB terminal for Page Up/Down (with optional cable)
SCANNING RATE
 [H] 15 - 80 kHz, [V] 50 - 85 Hz, [Dot Clock] max 110 MHz

AUDIO SPEAKER
 2 W Mono
HEIGHT ADJUSTER
 Rearward lifting leg x 2, Push button front leg x 1

HAND REMOTE UNIT
 1) Projector fully control, 2) Power Point™ Page Up/Down via USB (with optional cable)
POWER CONSUMPTION
 280W/2.9A

WEIGHT
 10.28 x 8.58 x 3.42 inches (L x W x H)
POWER REQUIREMENTS
 529 lbs.
 AC 100-240V, 50/60 Hz
FAN NOISE
 36 dBA (Low mode: 30 dBA)

SUPPLIED ACCESSORIES
 • Remote control
 • Power cable
 • VGA (D-sub) cable
 • Composite cable
 • Owner's manual (CD-ROM)
 • Quick Guide

OPTIONAL ACCESSORIES
 Replacement Lamp (VLT-XD205LP), Ceiling Mount (PROJ-UCM), Hard Shell Rolling Case(DKT1-A1AC), Soft Carry Case (XL1-SSCC)

WARRANTY
 3-years or 10,000-hours on the TI-DLP DMD Chip, 3-years parts and labor, 3-years Express Replacement Assistance (ERA), 90-days lamp warranty

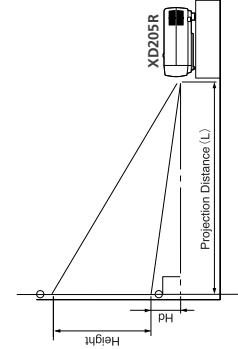

Diagonal Size	SCREEN		DISTANCE FROM SCREEN (L)				Hd	
	inch	cm	Max.Zoom	Min.Zoom	inch	cm	inch	cm
40	102	26	50	1.3	60	1.5	3.5	8.8
60	152	38	76	1.9	91	2.3	5.2	13.3
80	203	51	101	2.6	121	3.1	7.0	17.7
100	254	64	126	3.2	151	3.8	8.7	22.1
150	381	96	189	4.8	227	5.8	13.1	33.2
200	508	128	252	6.4	302	7.7	17.4	44.2
250	635	160	315	8.0	378	9.6	21.8	55.3
300	762	192	378	9.6	-	-	26.1	66.3

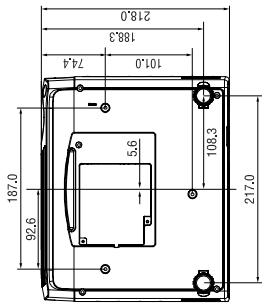

Unit measured in millimeters (mm)

MITSUBISHI DIGITAL ELECTRONICS AMERICA, INC.
 Presentation Products Division
 Toll Free: 888.307.0349
 Email: ppdinfo@mdea.com
www.mitsubishi-presentation.com

Canada
 Mitsubishi Electric Sales Canada Inc.
 Information Technologies Group
 Phone: 905.475.7728
www.mitsubishielectrc.ca



©2005 Mitsubishi Digital Electronics America, Inc. Standard features, options and specifications subject to change without notice. The DLP™ logo and DLP™ medallion are trademarks of Texas Instruments. Microsoft, Windows, and the Windows logo are registered trademarks of Microsoft Corporation. Mac and the Mac logo are trademarks of Apple Computer, Inc. registered in the U.S. and other countries. All other trademarks are the property of their respective holders.
 *The projector lamp contains mercury. Please dispose of properly.
 PP20069-11/05-15M-LITXD205R

